

Parade Line Up

Parade starts at 11:00 a.m. sharp

ALL CARS AND FLOATS THAT WANT TO BE JUDGED

MUST BE IN PLACE BY 9:00 A.M.

ONLY Vehicles in the Parade are allowed to park in Line-Up Areas

K Street Park = Horses are to be in place by 10:30 a.m.

Then you will move up 5th Street to the PMT parking lot to be toward the front of the parade.

5th St.

6th St.

7th St.

K St.

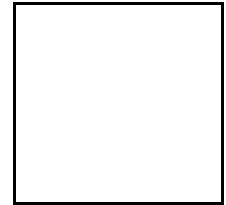

J St.

Commercial & Political Vehicles or Trailers



NO
Parking

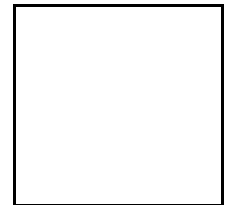

I St.

Commercial & Political Vehicles or Trailers

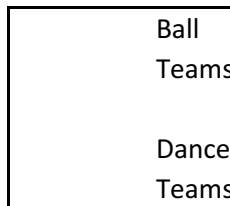

Ball
Teams
NO
Parking
Dance
Teams

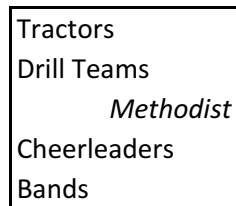

Tractors
Drill Teams
Methodist Church
Cheerleaders
Bands

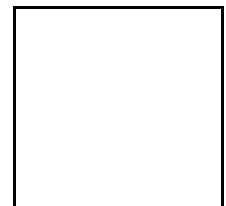

H St.

Floats on both sides of the

Emergency Vehicles & Government

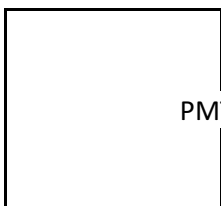

PMT Parking Lot

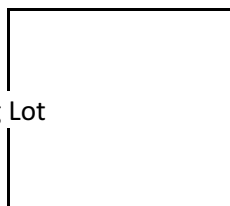

Mayor
Grand Marshall

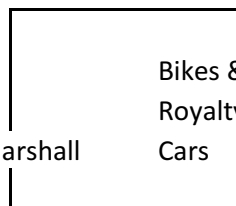

Bikes & Kids
Royalty
Cars

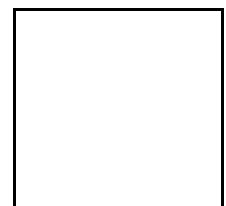

Hansen Mortuary

G St.

Color Guard / Police